

SPECIFICATION

FOUNDATION: WITH P.C.C 1:5:10 USING 40MM JELLY OVER SAND FILLING.

BRICK WORK: WITH FIRST QUALITY STOOD BRICKS IN 1:1.5 FOR FOUNDATION, BASEMENT/SUPERSTRUCTURE.

FLOORING: WITH P.C.C 1:5:10 FINISHED WITH MOSAIC.

PLASTERING: WITH C.M:1:5 12MM THICK FOR INTERNAL, EXTERNAL, CEILING AND FINISHED WITH 3COATS OF WHITE OR COLOUR WASHING.

R.C.C. FOR COLUMN, PLINTH BEAM, ROOF SLAB WITH C.C 1:2:4 USING REB. REINFORCEMENT.

WOOD WORK: WITH BEST QUALITY COUNTRY WOOD FINISHED WITH 3COATS OF PAINTING.

SCHEDULE OF JOINERY

D. COUNTRY WOOD DOOR 3'-3" X 7'-0" 1000 X 2100

D1. -DO- 3'-0" X 7'-0" 900 X 2100

D2. -DO- 2'-6" X 7'-0" 750 X 2100

W. COUNTRY WOOD GLAZED WINDOW 4'-6" X 4'-6" 1200 X 1350

W1. -DO- 3'-0" X 4'-6" 900 X 1350

V. VENTILATOR (RICHAVALI) 2'-0" X 2'-0" 600 X 600

PROPOSED	ROADS	BOUNDARY	BEVERAGE	PLOT AREA 1830 SQ. FT (OR) 170M ² PLINTH AREA GROUND FLOOR 884 SQ. FT (OR) 82 M ² FIRST FLOOR 884 SQ. FT (OR) 82 M ² TOTAL 1768 SQ. FT (OR) 164 M ² TERRACE FLOOR 128 SQ. FT (OR) 12M ² P.S. 1.6.97 COVERAGE 48%
----------	-------	----------	----------	---

PLAN SHOWING THE PROPOSED DWELLING RESIDENCE IN PLOT NO GA, S. NO. 64/12, 1ST CROSS STREET, PERUNGUDI VILLAGE KURUNJI NAGAR, PERUNGUDI TOWN PANCHAYAT, CHENNAI.

SCALE: 1:100

① K. Kalimuthu
② K. Kalimuthu
③ K. Kalimuthu

K. KALIMUTHU, D.C.E., S.E.
Consulting Engineer & Licensed Surveyor (No 353)
CORPORATION OF CHENNAI,
NO. 20, ANNA GARDEN,
VELACHERY MAIN ROAD (GIT GATE),
VELACHERY, CHENNAI - 600 042,
PH: 245 5502
LICENSED SURVEYOR

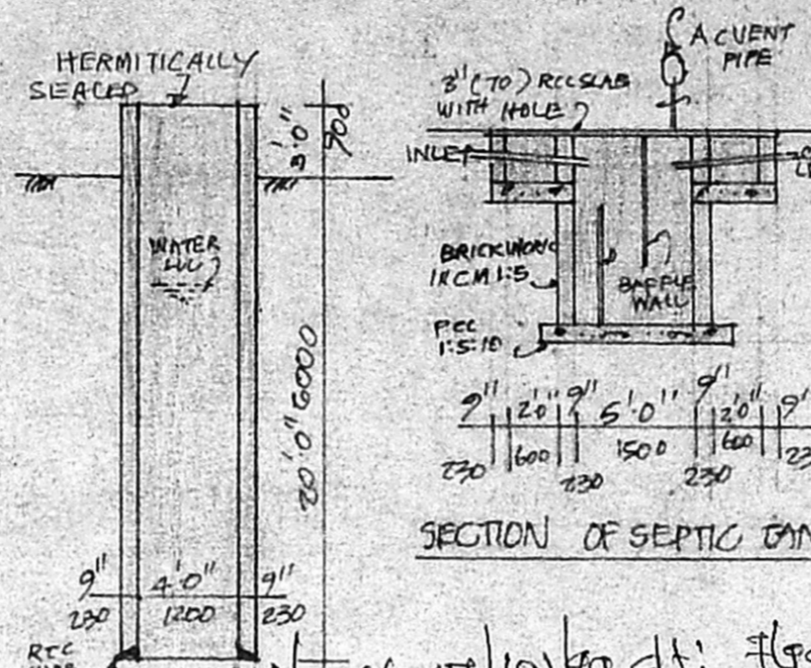
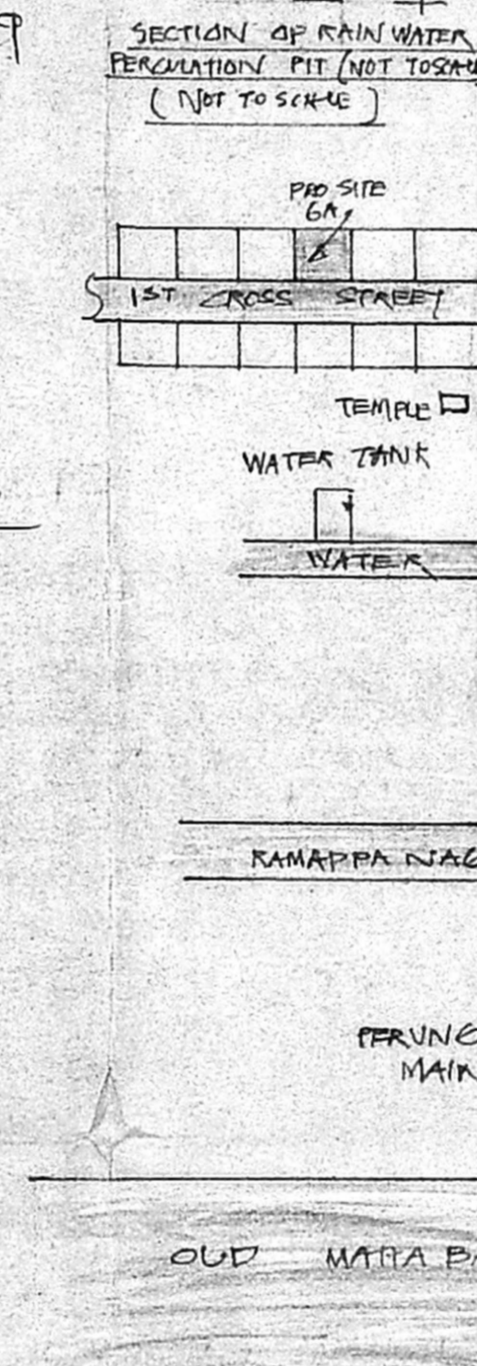
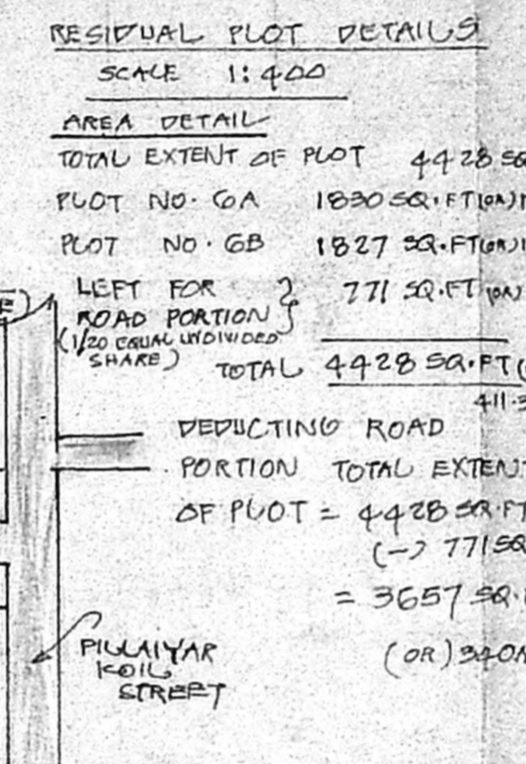
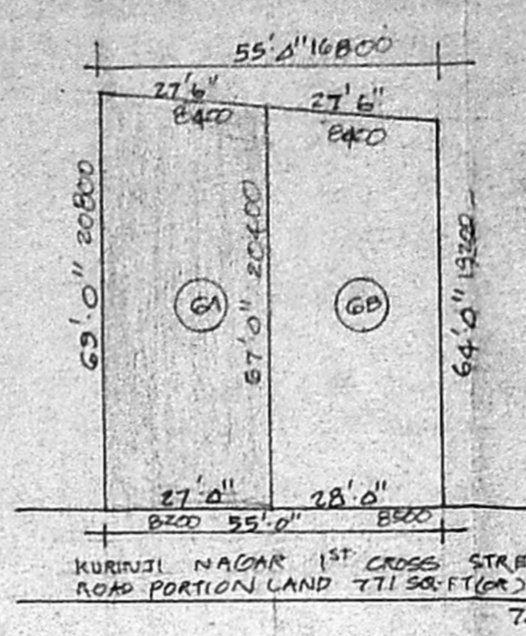

Planning Permit No. 26647/10/19 dt: 1/9/99

APPROVED

SUBJECT TO THE CONDITIONS IN THIS OFFICE LETTER

No. 111013/19 dt: 1/9/99

FOR MEMORANDUM METROPOLITAN DEVELOPMENT AUTHORITY CHENNAI 600 003.

